

## INSTALLATION INSTRUCTIONS

Thank you for purchasing a Quarter Master release bearing. Please take a few minutes to read through these instructions before you install your new Quarter Master Mechanical Release Bearing.

1. Remove the existing release bearing per the manufacturer's instructions.
2. Apply lubricant to the guide tube per the manufacturer's instructions. This is often a thick heat resistant grease.
3. Rotate the bearing fork into an extended position, so that the bearing can slide on.
4. Check the movement of the fork and bearing to ensure that the parts are seated and do not bind.
5. Install the bearing onto the fork and guide tube in the same position and orientation as the original bearing.
6. Continue with clutch installation per the manufacturer's instructions.

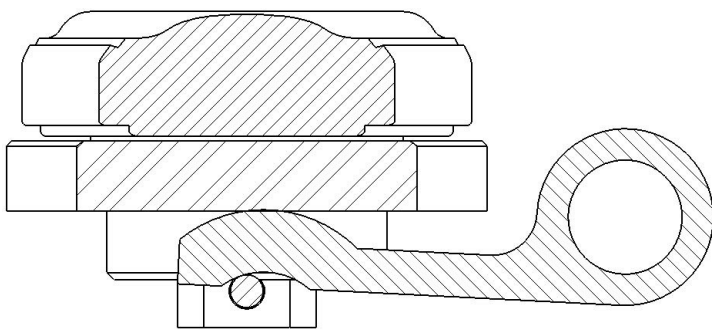

Figure 1: Partial cut-away view of release bearing and fork (P/N 236137)

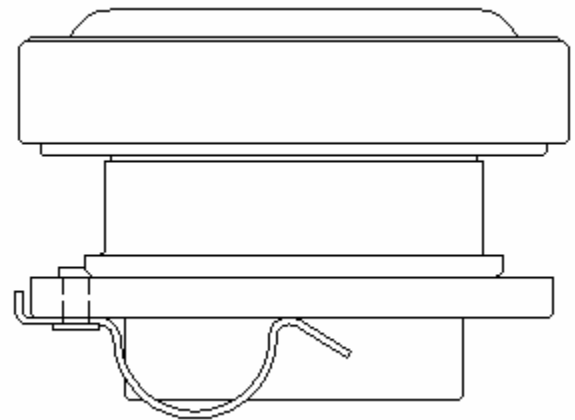

Figure 2: Ford Release Bearing (P/N 335302)

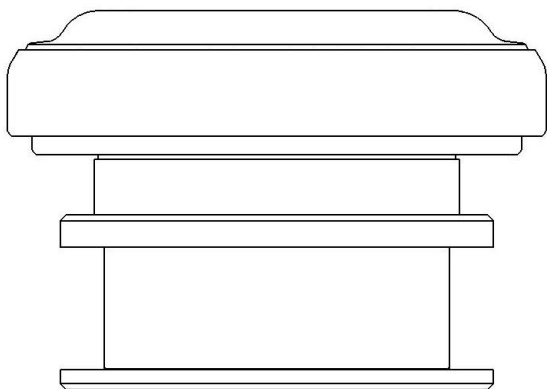

Figure 3: Ford Release Bearing (P/N 336297)

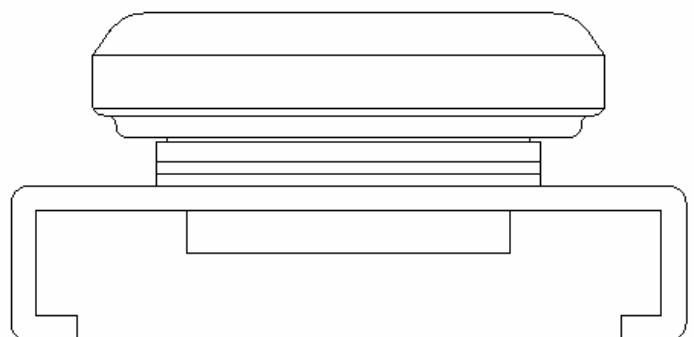

Figure 4: Mazda Release Bearing (P/N 236521)